

NOTE: BREAK ALL CORNERS WITH 0.015" (.38 MM) RADIUS UNLESS OTHERWISE NOTED. STANDARD TOLERANCES TO APPLY UNLESS OTHERWISE SPECIFIED.

CUSTOMER PART No.	CAN ART STD.	DIE No. EH05393
DESCRIPTION 1" SCHEDULE 80 PIPE		PROPOSAL No.

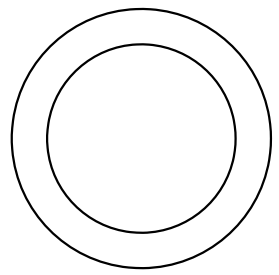
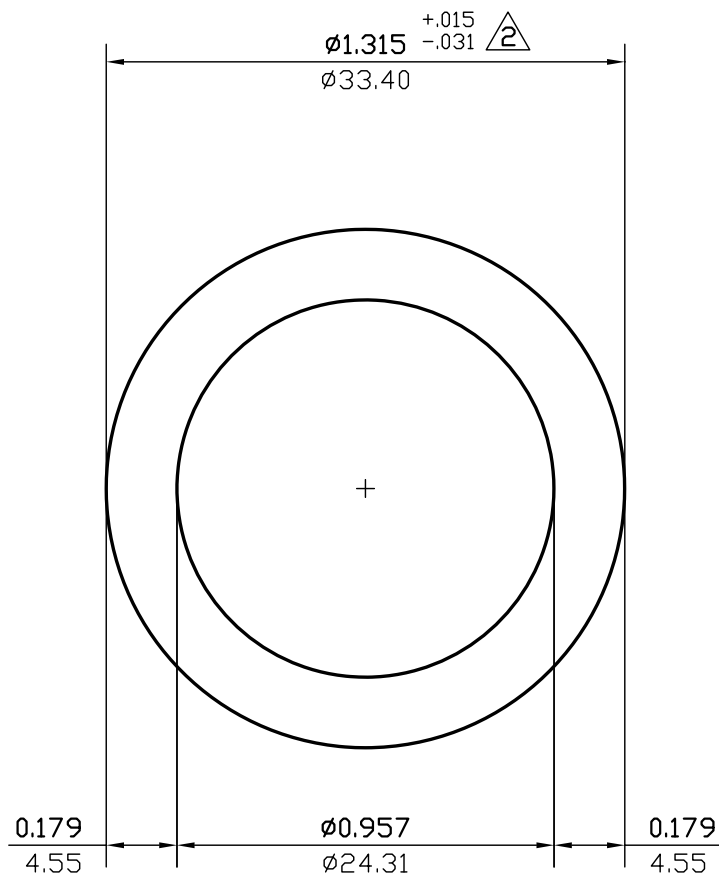

ACTUAL SIZE

WALL THICKNESS **0.179 (4.55)** EXCEPT AS SHOWN

DATE	REV	DESCRIPTION	BY
03/10/23	3	REMOVED ALLOY	JASON
07/14/15	2	ADDED +.015/-0.031 TOLERANCE.	P.M.
EST.AREA	0.639	IN. ²	EST.AREA 412 MM. ²
EST.WT.	0.754	LBS/FT.	EST.WT. 1.122 KG/M.
EST.PER.	7.138	IN.	EST.PER. 181.3 MM.
OUT PER.	4.131	IN.	OUT PER. 104.9 MM.
C.C.D.	1.315	IN.	C.C.D. 33 MM.
FACTOR 9	FINISH M/F	ALLOY & TEMP.	
CKD BY	SCALE 2:1	DWN BY J.D.	DATE 09/15/92

CAN ART

ALUMINUM EXTRUSION INC.

85 PARKSHORE DRIVE
BRAMPTON, ONT L6T 5M1
TEL. NO. (905) 791-1464
FAX NO. (905) 791-9151
E-MAIL: canart@canart.com

THIS DRAWING IS NOT NECESSARILY A COPY OF YOUR ORIGINAL. PLEASE APPROVE DIMENSIONS AND TOLERANCES INDICATED. CAN ART ASSUMES NO RESPONSIBILITY EITHER TECHNICAL OR LEGAL FOR HAVING THIS SHAPE MADE. THE CUSTOMER AGREES TO FULLY PROTECT CAN ART ALUMINUM FROM CLAIMS OF OTHERS RESULTING FROM THIS SHAPE.

SIGNED: _____ DATE: _____